

2. KAT I KROV - STAN 5 i 6 MJ 1:100

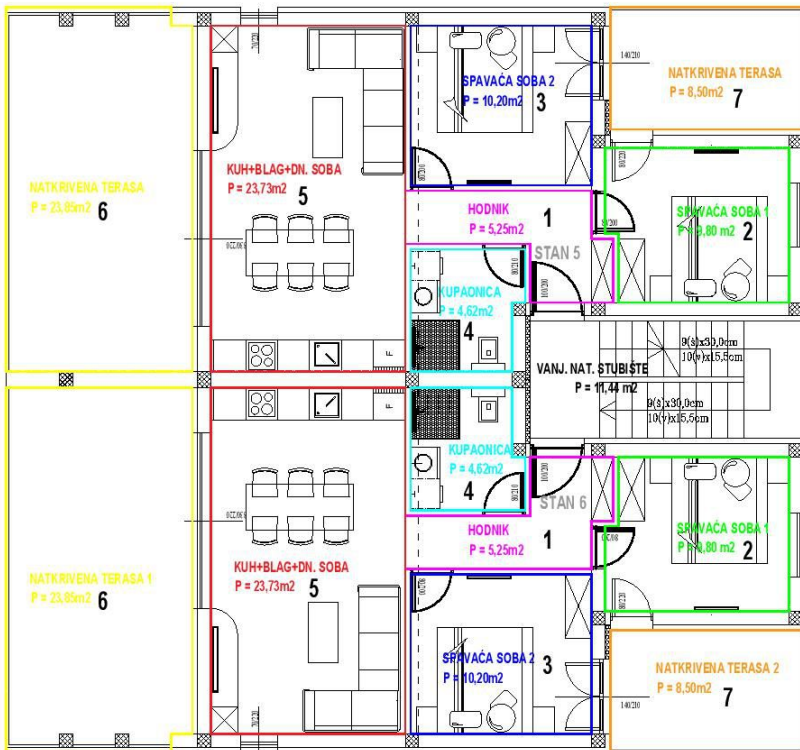
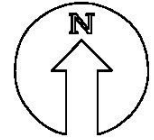

2. KAT - STAN 5

| BROJ | NAZIV | POVRŠINA (m ²) | KOEFICIJENT | POV. x KOEF. |
|------|---------------------------|-----------------------------|-------------|----------------------------|
| 1 | Hodnik | 5,25 | 1,0 | 5,25 |
| 2 | Spavaća soba 1 | 9,80 | 1,0 | 9,80 |
| 3 | Spavaća soba 2 | 10,20 | 1,0 | 10,20 |
| 4 | Kupaonica | 4,62 | 1,0 | 4,62 |
| 5 | Dn.sobi i blag. i kuhinja | 23,73 | 1,0 | 23,73 |
| 6 | Natkrivena terasa 1 | 23,85 | 0,5 | 11,93 |
| 7 | Natkrivena terasa 2 | 8,50 | 0,5 | 4,25 |
| 8 | Krovnna terasa | 87,90 | 0,25 | 21,98 |
| 9 | Parkirno mjesto 5 | 12,50 | 0,2 | 2,50 |
| | | 186,35 m² | | 94,26 m² |

2. KAT - STAN 6

| BROJ | NAZIV | POVRŠINA (m ²) | KOEFICIJENT | POV. x KOEF. |
|------|---------------------------|-----------------------------|-------------|----------------------------|
| 1 | Hodnik | 5,25 | 1,0 | 5,25 |
| 2 | Spavaća soba 1 | 9,80 | 1,0 | 9,80 |
| 3 | Spavaća soba 2 | 10,20 | 1,0 | 10,20 |
| 4 | Kupaonica | 4,62 | 1,0 | 4,62 |
| 5 | Dn.sobi i blag. i kuhinja | 23,73 | 1,0 | 23,73 |
| 6 | Natkrivena terasa 1 | 23,85 | 0,5 | 11,93 |
| 7 | Natkrivena terasa 2 | 8,50 | 0,5 | 4,25 |
| 8 | Krovnna terasa | 87,90 | 0,25 | 21,98 |
| 9 | Parkirno mjesto 6 | 12,50 | 0,2 | 2,50 |
| | | 186,35 m² | | 94,26 m² |

